

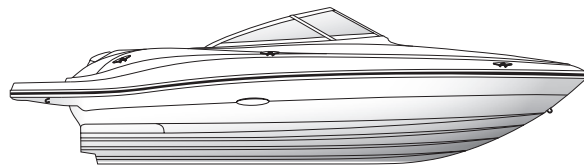

---

## Owner's Manual

# 200 Sundeck



Manual Part Number: MRP 2029328



---

# WELCOME

---

Congratulations on becoming the new owner of a Sea Ray® Boat, the world's most prestigious manufacturer of boats. We welcome you into our worldwide and ever-expanding family of boating enthusiasts.

This Owner's Information Packet, should be kept on board your Sea Ray®, and will provide important information about features of your boat.

For years of trouble-free boating, take the time to carefully review the information in this package and really get to know your boat. **Have everyone who will operate your boat read the Owner's Manual.**

The Owner's Information Packet contains the following:

- **Sea Ray® Owner's Manual**

The Sea Ray Owner's Manual contains important operating and safety information, as well as reminding you about your responsibilities as a boat owner/operator.

- **Model Specific Owner's Manual**

The Model Specific manual contains information specific to your model.

- **Original Equipment Manufacturer (OEM) Information**

The OEM Information of your Owner's Information Packet contains information provided by the individual systems manufacturers of equipment installed on your boat. Examples include the engine, engine control and electronics equipment. Throughout the Owner's Manual you will be referred to information provided by manufacturers of specific systems.

For a complete library of all Sea Ray manuals including owners, systems, accessories, and options please visit [www.searay.com](http://www.searay.com). There you will be able to view all Sea Ray manuals and any items that are not included in this manual.

Because your purchase represents a substantial investment, we know you will want to take the necessary measures to protect its value. We have outlined a program for proper operation, periodic maintenance and safety inspections. We urge you to follow these recommendations. If you have questions which are not fully covered by the Owner's Information Package, please consult your authorized Sea Ray® Boats dealer for assistance.

Thank You For Selecting A Sea Ray®!  
Bon Voyage

The logo for Sea Ray Boats, featuring the brand name in a stylized, cursive script with a registered trademark symbol.

Please visit [www.searay.com](http://www.searay.com) for a complete library of all Sea Ray Owner's and Accessory Manuals.

Information in this publication is based upon the latest product specifications available at printing. Sea Ray® Boats, Inc. reserves the right to make changes at any time, without notice, in the colors, equipment, specifications, materials and prices of all models, or to discontinue models. Should changes in production models be made, Sea Ray® is not obligated to make similar changes or modifications to models sold prior to the date of such changes.

Printed in the U.S.A. July 2010  
© Sea Ray Boats, Inc. • A Brunswick Company

Sea Ray Boats, Inc. 2600 Sea Ray Blvd., Knoxville, TN 37914

Note: Not all accessories shown in pictures or described herein are standard equipment or even available as options.

The following are registered trademarks of the Brunswick Corporation: Sea Ray® & The SR Wave Logo

*Sea Ray* ®



---

# TABLE OF CONTENTS

---

## INTRODUCTION v

1. This Manual .....	v
2. Your Responsibilities .....	v
3. Sources of Information.....	v
4. Dealer Responsibilities .....	vi
5. Warranties.....	vi
6. Hull Identification Number (HIN) .....	vi
7. Manufacturer's Certification .....	vii
8. Service, Parts and Repair for Your Boat .....	vii
9. Warranty Information.....	vii

## 200 SUNDECK OWNERS MANUAL 1

1. Load Capacity.....	1
2. Passenger Locations .....	1
3. Safety Label Locations .....	2
4. Basic Boat Dimensions and Clearances .....	4
5. Function and Location of Through-Hull Cutouts .....	5
6. Helm, Gauge & Switch Layout.....	6
7. Deck Layout.....	7
8. Cleats.....	8
9. Navigation and Anchor Lights.....	8
10. Bilge Layout .....	8
11. Fuel System.....	8
12. Entertainment System .....	9
13. Canvas.....	9
14. Transom Trailer Trim Switch (Optional).....	9
15. Water Sports Tower.....	10
16. Electrical Schematics.....	10

## INDEX I





---

# INTRODUCTION

---

## 1. THIS MANUAL

The material here and in the rest of the Owner's Information Packet:

- Gives you basic safety information;
- Describes the fundamentals of boat use;
- Describes the features of your boat;
- Describes the equipment on your boat;
- Contains service and maintenance information.

**You must learn to safely operate this boat as well as read, understand and use the information contained in this package.**

What these manuals do not give you is a course in boating safety, or how to navigate, anchor, or dock your boat. Operating a power boat safely requires more skills, knowledge, and awareness than is necessary for a car or truck.

## 2. YOUR RESPONSIBILITIES

For your safety, the safety of your passengers, other boaters and people in the water, you must:

- Take a boating safety course;
- Get instruction in the safe and proper handling of your boat;
- Understand and follow the "Rules of the Road";
- Learn how to navigate;
- Register:

You must register this boat in the state where it will be used most frequently, many states require additional registration when an out-of-state boat is used within their boundaries.

Contact state boating authorities or any marine dealer for registration requirements.

## 3. SOURCES OF INFORMATION

In North America, contact one of the following for boating courses:

- U.S. Coast Guard Auxiliary
- U.S. Power Squadron
- Canadian Power and Sail Squadrons
- Red Cross
- State Boating Offices
- Yacht Club

Contact your dealer or the Boat/U.S. Foundation at:

**1-800-336-2628**

Outside of North America, contact your boat dealer and/or your governmental boating agency for assistance.

A book that provides a comprehensive background in boating is **Chapman - Piloting, Seamanship and Small Boat Handling**, by Elbert S. Maloney, published by Hearst Marine.



---

# INTRODUCTION

---

## 4. DEALER RESPONSIBILITIES

In addition to a predelivery check and service of the boat, your dealer is to give you:

- A description and demonstration of the safety systems, features, instruments and controls on your boat;
- An orientation in the general operation of your boat;
- An “In Service Check List” form completed by you and the dealer after your inspection of the boat;
- A review of all warranty information and how to obtain warranty service;
- The Owner Information Package.

If you do not receive all of these materials, or have any questions, contact your dealer.

## 5. WARRANTIES

Your boat comes with several warranties. Each component and/or system on your boat has its own warranty that will be found with the specific information and manual for that component. These are included with your Owner’s Manual Packet. The Sea Ray® Express Limited Warranty is on the warranty information sheet and in this manual. Please locate and read the individual warranties.

## 6. HULL IDENTIFICATION NUMBER (HIN)

The “Hull Identification Number”, (Fig. ix.1) will be located either on the starboard side of the transom, or on the aft, starboard side of the gunwale, and is your boat’s most important identifying factor. This number must be included in all correspondence and orders. Failure to include it creates delays. Also of vital importance is the engine serial number and part number when writing about or ordering parts for your engine. Refer to the Engine Operator’s Manual for location of engine serial number and record it for future reference.

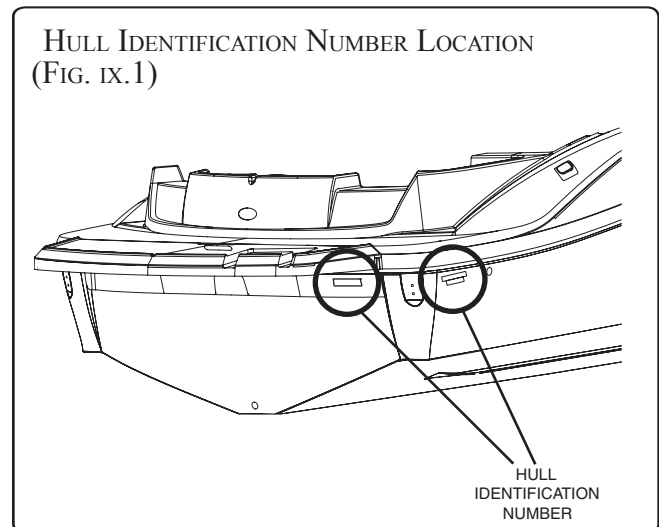



---

# INTRODUCTION

---

## 7. MANUFACTURER'S CERTIFICATION

As a boat manufacturer, Sea Ray® builds their products to guidelines established under the Federal Boat Safety Act of 1971. The Act is promulgated by the United States Coast Guard who has authority to enforce these laws on boat manufacturers that sell products in the United States. Sea Ray® ensures that all of its products comply with these laws.

The National Marine Manufacturers Association (NMMA) provides Sea Ray® with a third party certification. The NMMA is an organization that represents the marine industry and assists manufacturers, boat dealers, marinas, repair yards and component suppliers in areas of legislation, environmental concerns, marine business growth and state and federal government agency interaction. The third party certification that Sea Ray® participates in, uses the well known Standards and Recommended Practices of the American Boat and Yacht Council (ABYC).

Sea Ray® Boats participates extensively in the American Boat and Yacht Council which is a nonprofit organization that develops and publishes voluntary standards and recommended practices for boat and equipment design, construction, service and repair. We utilize all applicable ABYC standards in the construction of your Sea Ray® boat.

Finally, Sea Ray® sells their products world wide and as such must conform to the various rules and regulations required by other countries. Most notably, are the ISO standards in Europe which require the application of the Common European (CE) mark. This mark, much like the NMMA certification here in the US, gives you the boat owner specific information concerning your craft.

## 8. SERVICE, PARTS AND REPAIR FOR YOUR BOAT

When your boat needs service, parts or repair, take it to an authorized Sea Ray® dealer. To find a dealer in your area contact Sea Ray® via the internet at [www.searay.com](http://www.searay.com) (international customers please visit [international.searay.com](http://international.searay.com)).

To find repair and parts facilities for the equipment installed on your boat, refer to the section or manual for that component.

If a problem is not handled to your satisfaction:

1. Discuss any warranty-related problems directly with the service manager of the dealership or your sales person. Give the dealer an opportunity to help the service department resolve the matter for you.
2. If a problem arises that has not been resolved to your satisfaction by your dealer, contact Sea Ray® via the internet at [www.searay.com](http://www.searay.com) and the appropriate customer service information will be provided to you.

## 9. WARRANTY INFORMATION

You will find information regarding the Sea Ray® warranty following the introduction. A warranty information card is also included in the owner information packet. If for some reason this information missing, contact your Sea Ray® dealer.





**ABOUT YOUR LIMITED WARRANTY**

Sea Ray® offers an express Limited Warranty on each new Sea Ray® purchased through an authorized Sea Ray® dealer. A copy of the Limited Warranty was included in your owner's manual package. If for any reason, you did not receive a copy of the Limited Warranty, please contact your local dealer for a replacement copy. This is a summary of several provisions of the Limited Warranty. Please read the Limited Warranty, which is the controlling document.

Under the Limited Warranty, Sea Ray® covers: (a) structural fiberglass deck or hull defects which occur within five (5) years of the date of delivery; (b) parts found to be defective in factory material or workmanship within one (1) year of the date of delivery; (c) laminate blisters resulting from defects in factory material or workmanship for five (5) years on a prorated basis.

Sea Ray®'s obligation under the Limited Warranty is limited to repair or replacement of parts that are judged defective by Sea Ray® and does not include transportation, haul out, or other expenses. The foregoing is the **sole and exclusive** remedy provided by Sea Ray®.

The Limited Warranty does not cover engines, stern drives, controls, propellers, batteries, trailers, or other equipment or accessories carrying their own individual warranties, nor does the Limited Warranty cover engines, parts or accessories not installed by Sea Ray®. The Limited Warranty does not cover cosmetic gel coat finish. Boats used for commercial purpose are excluded from coverage. **See the Sea Ray® Limited Warranty for other exclusions.**

**SEA RAY® EXPRESSLY DISCLAIMS THE IMPLIED WARRANTIES OF MERCHANTABILITY AND FITNESS. NEITHER SEA RAY® NOR THE SELLING DEALER SHALL HAVE ANY RESPONSIBILITY FOR LOSS OF USE OF THE BOAT, LOSS OF TIME, INCONVENIENCE, COMMERCIAL LOSS OR CONSEQUENTIAL DAMAGES.**

The unexpired term of the limited warranty may be transferred to a subsequent owner upon the new owner's request, except this limited warranty will not transfer to any subsequent owner of a boat which has been salvaged or resold after declaration of a total loss or a constructive total loss, i.e., the cost of repair exceeds the value of the boat. The new owner can submit this request, free of charge, via the searay.com website or through a local authorized Sea Ray Dealer where processing fees may be applied. Sea Ray reserves the right to reject any warranty transfer request for a boat that has been damaged, neglected, or otherwise previously excluded from warranty..

**Thank you for your decision to buy a Sea Ray®.**

The Sea Ray® Limited Warranty is subject to change at any time at Sea Ray's discretion. The information contained herein is general information about the Limited Warranty for the owner's general knowledge, but does not alter or amend the terms of the Limited Warranty.



# 200 SUNDECK OWNERS MANUAL

## 1. LOAD CAPACITY

Refer to the General Information Manual for a detailed explanation of **Load Capacity**.

### **! DANGER**

Never carry more weight or passengers than indicated on the certification plate, regardless of weather or water conditions.

The boat can capsize, swamp or sink.

BUILDER'S PLATE (INTERNATIONAL)  
(FIG. 1.1)

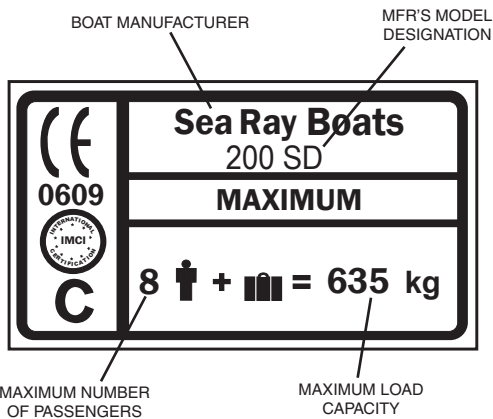

BUILDER'S PLATE (DOMESTIC)  
(FIG. 1.2)

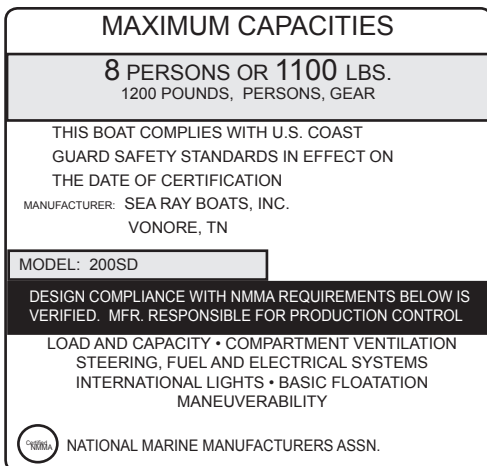

## 2. PASSENGER LOCATIONS

Refer to the General Information Manual for a detailed explanation of **Passenger Locations**.

### **! WARNING**

Boat motion can be erratic.

You can fall overboard or be injured by hitting something in or on the boat.

All persons must be in cockpit area or cabin and be prepared for sudden boat movement.

Use front or bow deck area only during anchoring, mooring or emergencies.

### **! WARNING**

Wet decks are slippery.

You can be seriously injured if you slip and fall.

Wear slip resistant footwear secured to your feet and hold on to rails or boat structure.

PASSENGER LOCATIONS  
(FIG. 1.3)

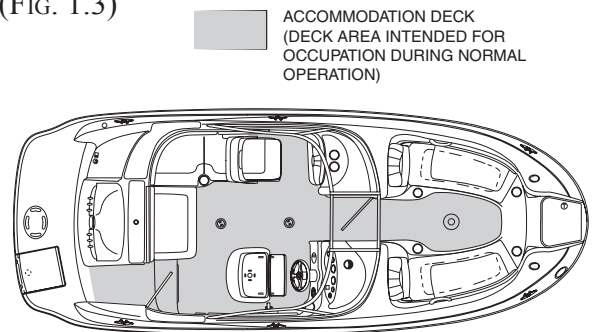

### **! DANGER**

Rotating propellers can injure or kill you.

Shut off engine when persons are in water near boat, or on swim platform or ladder.

### **! WARNING**

Rear facing transom seats **MUST NOT** be used while engine is running or boat is moving.





# 200 SUNDECK OWNERS MANUAL

## SAFETY LABEL LOCATIONS (CONTINUED)

SAFETY LABEL LOCATIONS  
(FIG. 3.1)

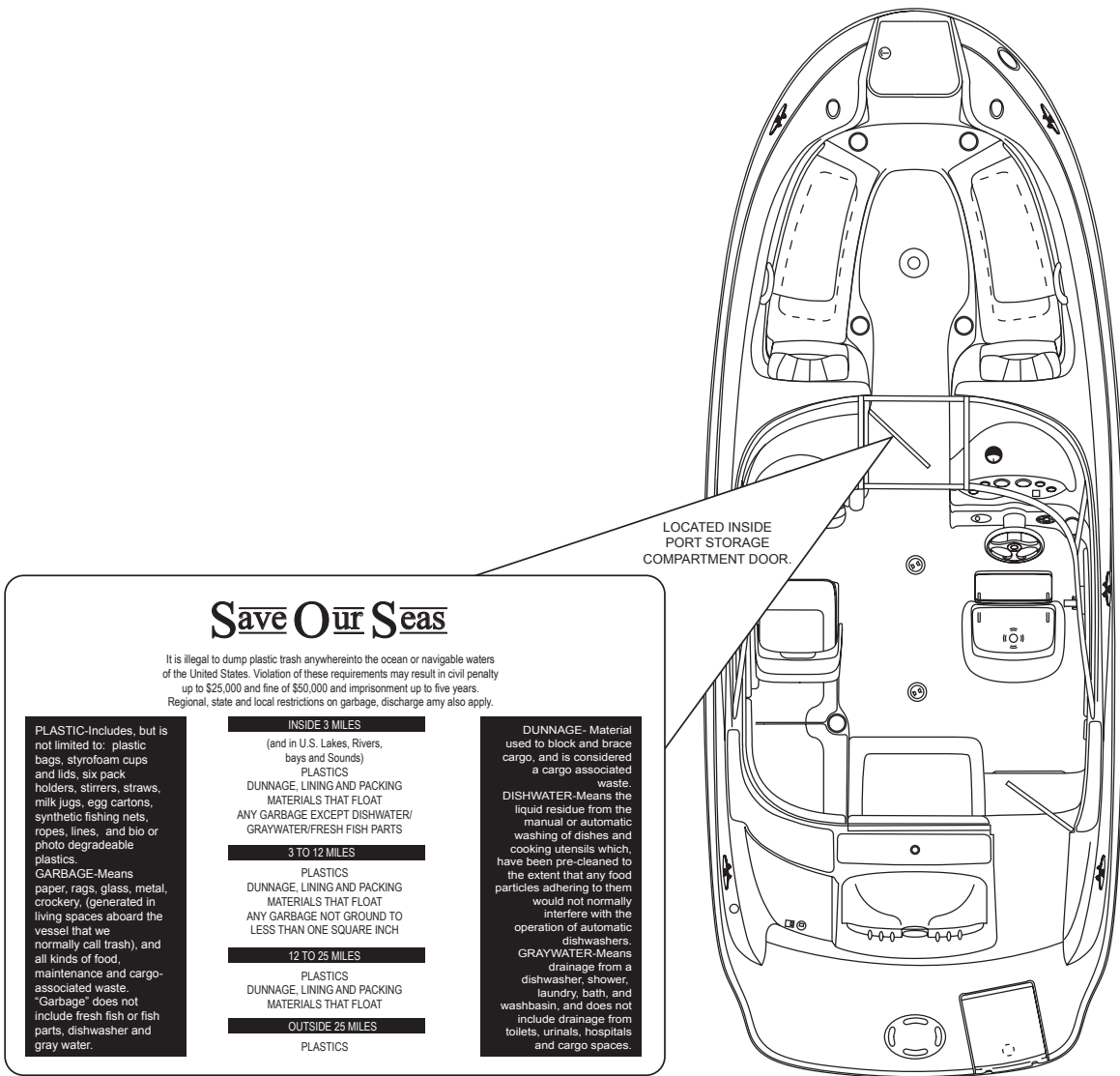

# 200 SUNDECK OWNERS MANUAL

## 4. BASIC BOAT DIMENSIONS AND CLEARANCES

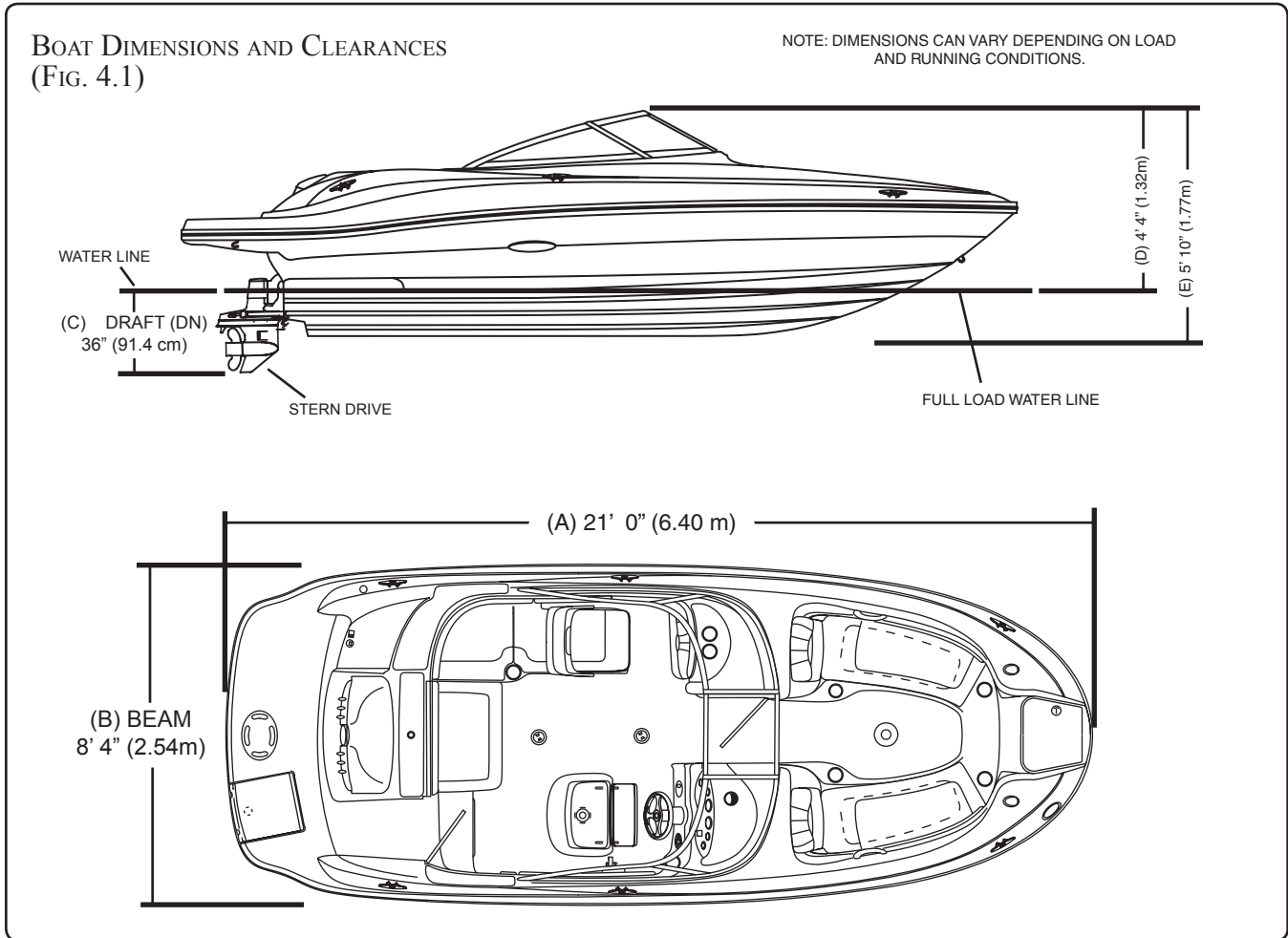

### 200 SUNDECK SPECIFICATIONS

(A) Overall Length .....	21ft. 0in.	6.40m
(B) Beam (Width).....	8ft. 4in.	2.54m
(C) Draft (Stern Drive Down) .....	36"*	91.4cm*
*MINIMUM WATER DEPTH TO PREVENT RUNNING AGROUND		
(Stern Drive Up).....	20"	50.8cm

Dry Weight.....	3,550 lbs.	1,610.3 kg.
Fuel Capacity.....	40 gal.	151.4 liters
Useable Fuel .....	38 gal.	143.8 liters
Dead Rise.....	20°	

### HEIGHT DIMENSIONS

(D) Waterline to Top of Windshield.....	4ft. 4in.	1.32 m
(E) Keel to Top of Windshield.....	5ft. 10in.	1.77 m





# 200 SUNDECK OWNERS MANUAL

## 5. FUNCTION AND LOCATION OF THROUGH-HULL CUTOUTS

PORT THROUGH-HULL CUTOUTS  
(FIG.5.1)

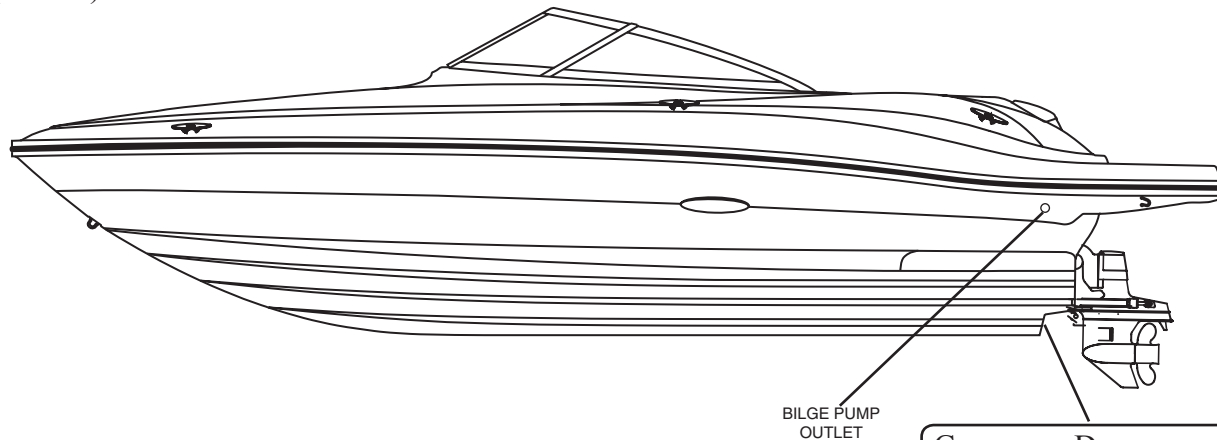

GARBOARD DRAIN  
(FIG. 5.3)

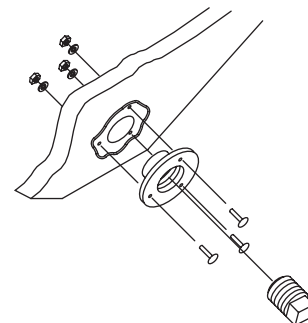

BILGE THROUGH-HULL CUTOUTS  
(FIG. 5.2)

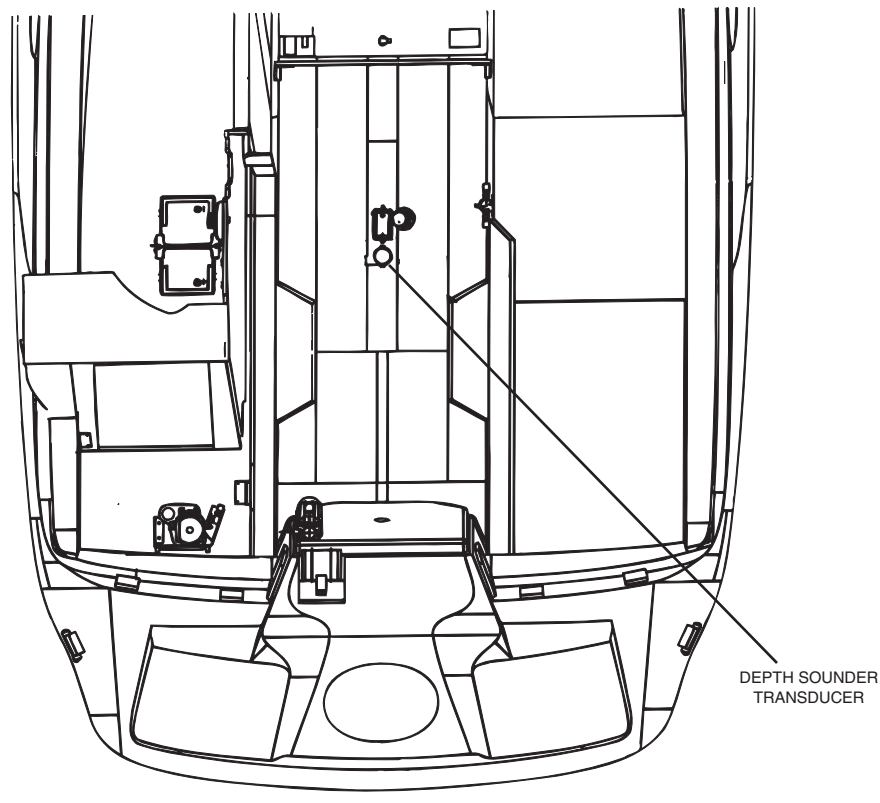

# 200 SUNDECK OWNERS MANUAL

## 6. HELM, GAUGE & SWITCH LAYOUT

HELM, GAUGE & SWITCH LAYOUT  
(FIG. 6.1)

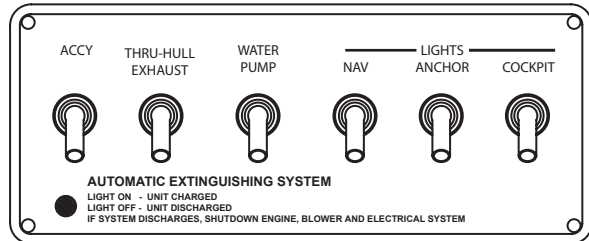
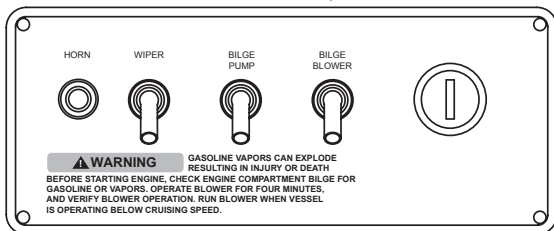
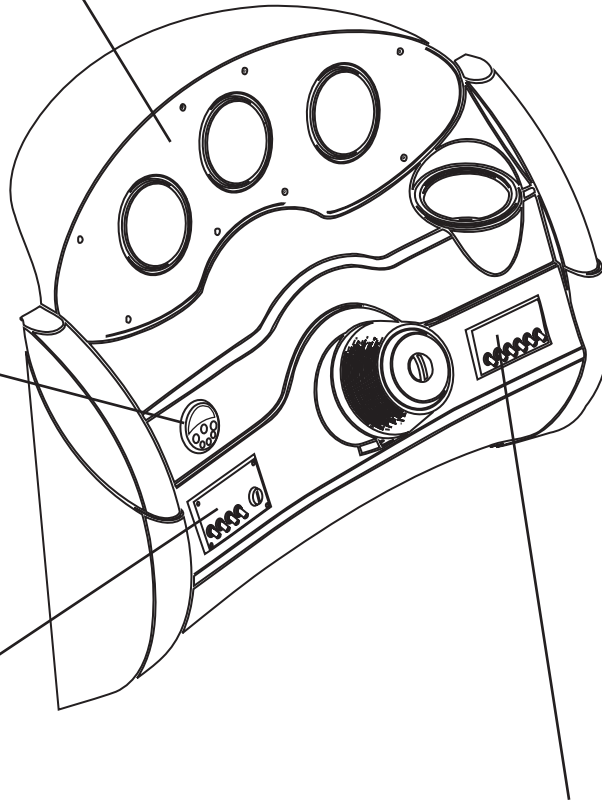
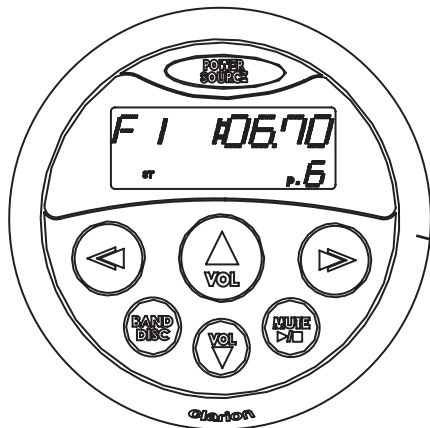
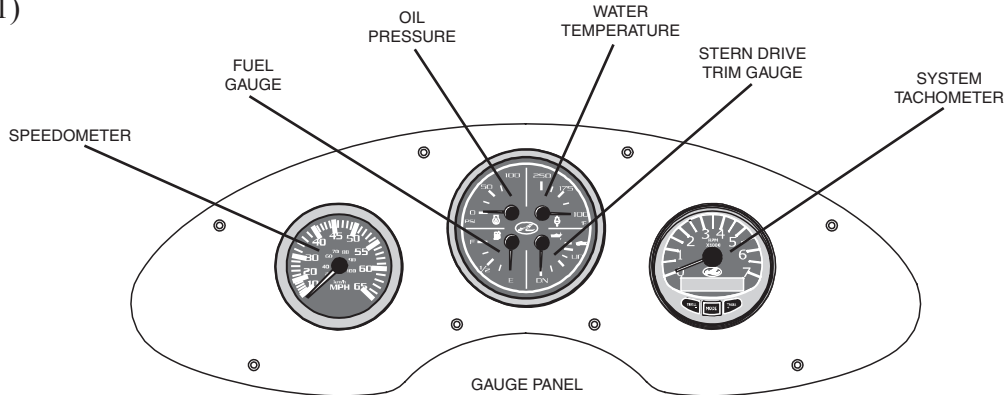



# 200 SUNDECK OWNERS MANUAL

## 7. DECK LAYOUT

GENERAL LAYOUT  
(FIG. 7.1)

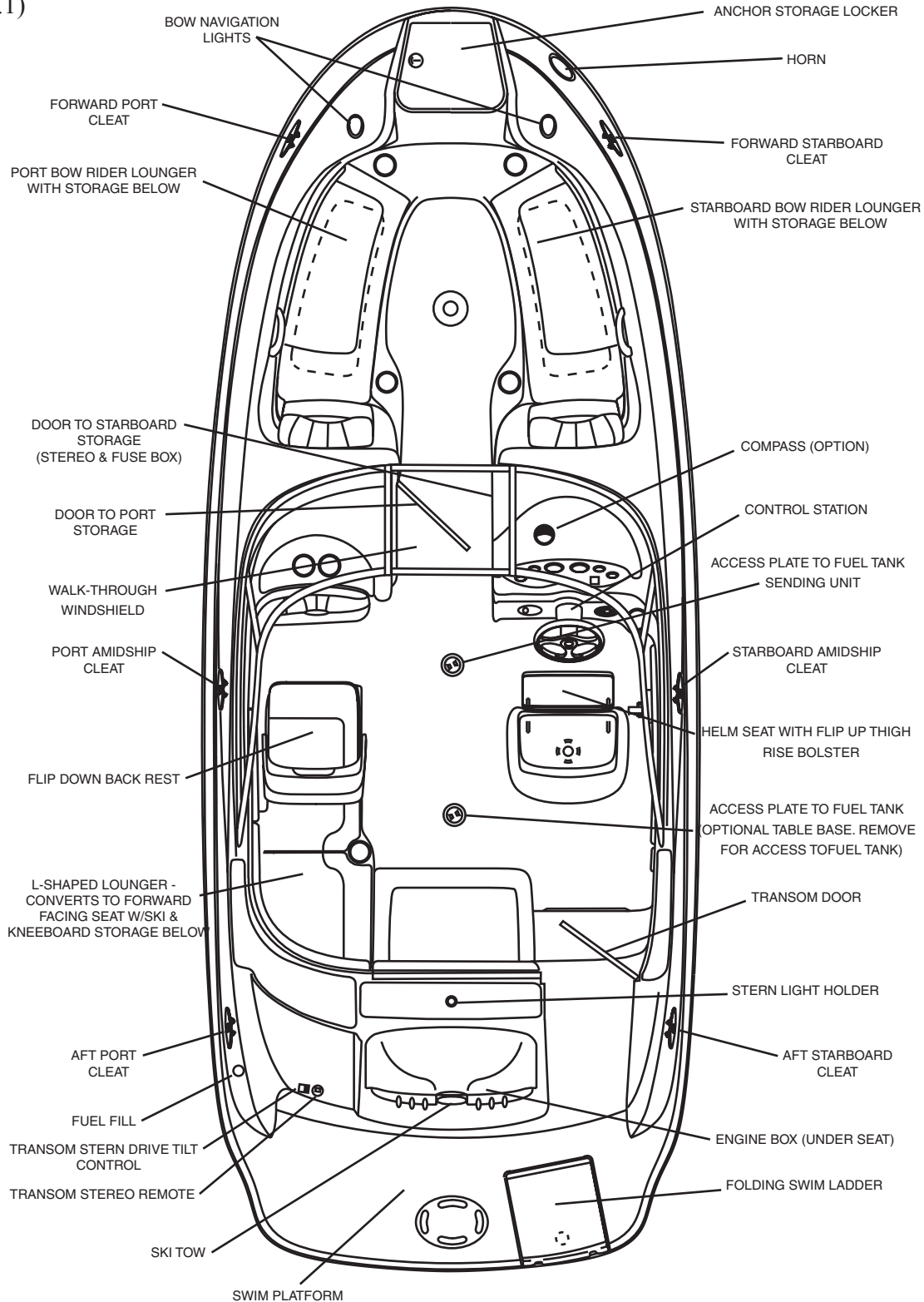

# 200 SUNDECK OWNERS MANUAL

## 8. CLEATS

Cleats must not be used for lifting the boat; they are intended for docking or mooring use only.

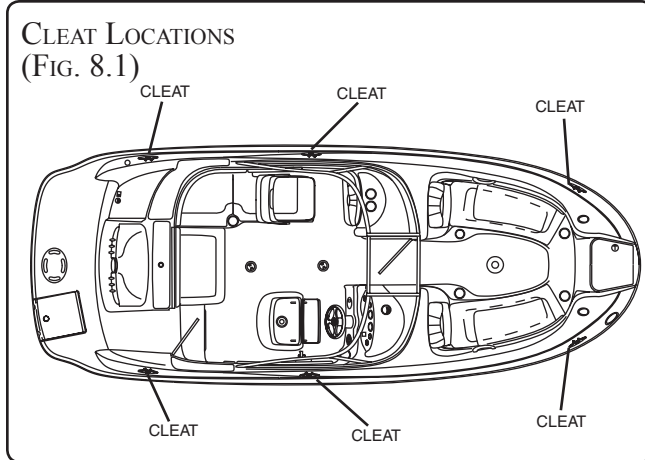

## 9. NAVIGATION AND ANCHOR LIGHTS

See General Information Manual for a detailed explanation of the anchor lights.

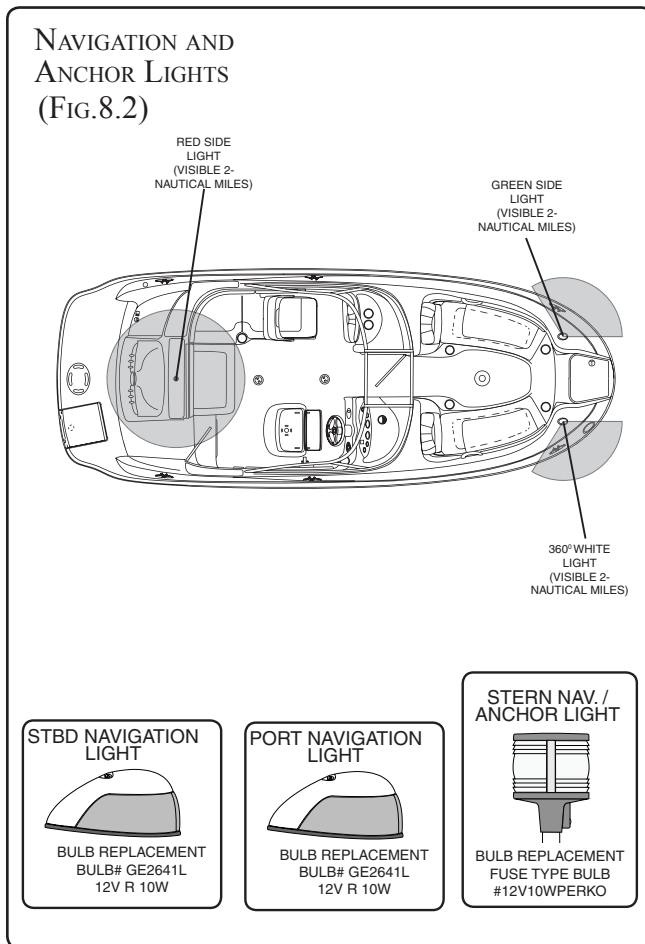

## 10. BILGE LAYOUT

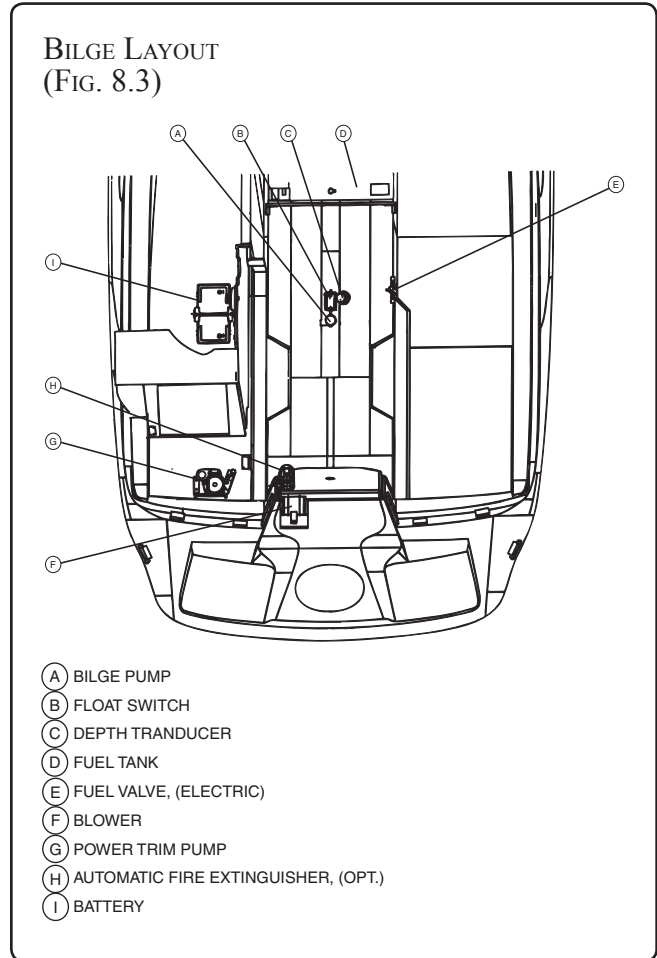

## 11. FUEL SYSTEM

The 200 Sundeck standard gasoline fuel system consists of a 40 gallon (151 liter) fuel tank, fuel tank vent, anti-siphon valve, engine fuel supply line and fuel fill.

The fuel tank vent serves as a pressure/vacuum release and safety overflow. The fuel vent is located inside the fuel cap on the port aft deck. Periodically check the vent to ensure that it is not clogged. The fuel pickup at the fuel tank has an anti-siphon valve to prevent fuel from siphoning out in the event of fuel line failure.



# 200 SUNDECK OWNERS MANUAL

## 12. ENTERTAINMENT SYSTEM

The 12 volt AM/FM radio single CD stereo is located in the port glove box.

The system includes two (2) water proof speakers. The Premier Stereo upgrade includes an amplifier, power antenna, four (4) speakers, a digital remote control located at the control station, an MP3 device port and is satellite radio ready.

STEREO SYSTEM (12 VOLT AM/FM RADIO & CD)  
(FIG. 9.1)

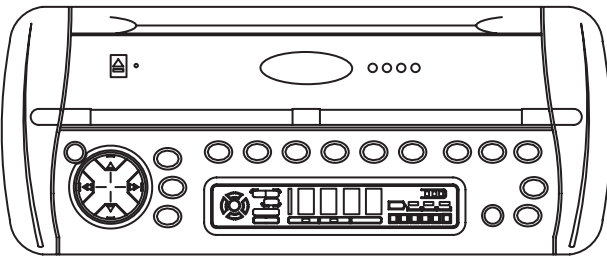

AM/FM RADIO, SINGLE CD UNIT, (LOCATED IN THE PORT GLOVEBOX)

STEREO REMOTE (LOCATED ON THE DASH)  
(FIG. 9.2)

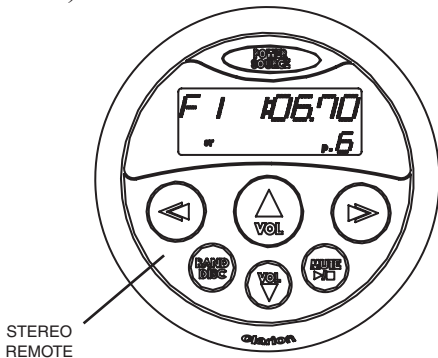

STEREO  
REMOTE

## 13. CANVAS

The standard canvas set for the 200SD consists of a bimini top with boot.

The following canvas options are available.

Bimini Aft Curtain  
Canvas Storage Bag  
Cockpit Cover

Side Curtains  
Front Curtains  
Tonneau Cover

## ⚠ DANGER

Exhaust fumes from engines contain deadly carbon monoxide gas (CO). Boats enclosed with canvas or with poor ventilation are most likely to collect fumes.

CO sickness symptoms include headache, nausea and dizziness. Do not mistake these symptoms for sea sickness.

Ventilate boat. See Section 1.4, Carbon Monoxide, for more details.

Do not use the rear (aft) curtain while engine is running or boat is moving.

## 14. TRANSOM TRAILER TRIM SWITCH (OPTIONAL)

A transom-mounted power trim switch is available for the convenience of raising the drive unit to the TRAILERING position while at the rear of the boat.

## ⚠ CAUTION

Use transom-mounted power trim switch to tilt for trailering only. Tilting drive unit into trailering zone while underway can damage the drive unit or engine.

TRANSOM TRAILER TRIM SWITCH (OPTIONAL)  
(FIG. 9.3)

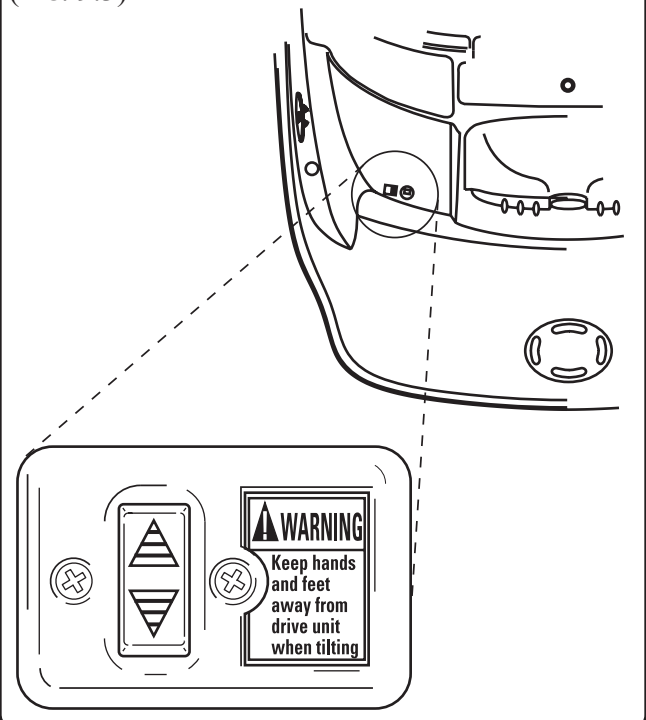

## 15. WATER SPORTS TOWER

### **! WARNING**

DO NOT USE TOWER FOR PULLING INFLATABLES. Use water sports tower for single skier/wakeboarder only. Use ski tow or stern eyes on transom for all other tow behind sports. Heavy loads could collapse tower causing personal injury.

### **! WARNING**

DO NOT USE WATER SPORTS TOWER FOR TOWING ANOTHER BOAT OR BEING TOWED. TOWER COULD COLLAPSE AND CAUSE INJURY. SEE OWNER'S MANUAL FOR INSTRUCTIONS ON TOWING.

WATER SPORTS TOWER (OPTIONAL)  
(FIG. 10.1)

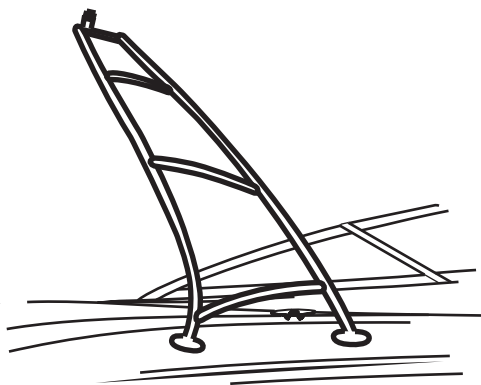

If equipped, the water sports tower provides a raised attach point (ski tow pylon) for the ski rope. The high attach point enables the skier to perform a wide variety of skills not capable with the lower transom attach point.

The tower attach point is intended for use only when towing a single skier. If you are towing multiple skiers or water toys carrying more than one person use only the transom attach point. The tower attach point is NOT intended for towing inflatables.

## 16. ELECTRICAL SCHEMATICS

This owner's manual contains electrical schematics and wiring harness illustrations for your boat. These electrical schematics were generated by electrical CAD designers at the engineering division for technical reference and service technicians. Sea Ray® does not recommend that you attempt to work on the boat's electrical system yourself. Instead, we recommend that you take your boat to your authorized Sea Ray® dealer for service. Sea Ray® reserves the right to change or update the electrical system on any model at any time without notice to the consumer and is NOT obligated to make any updates to units built prior to changes.

# 1. ELECTRICAL SCHEMATICS, 200 SUNDECK

DC WIRING DIAGRAM (1 OF 2)  
DRAWING NO. 09-603 (1 OF 2)  
(Fig. 11.1)

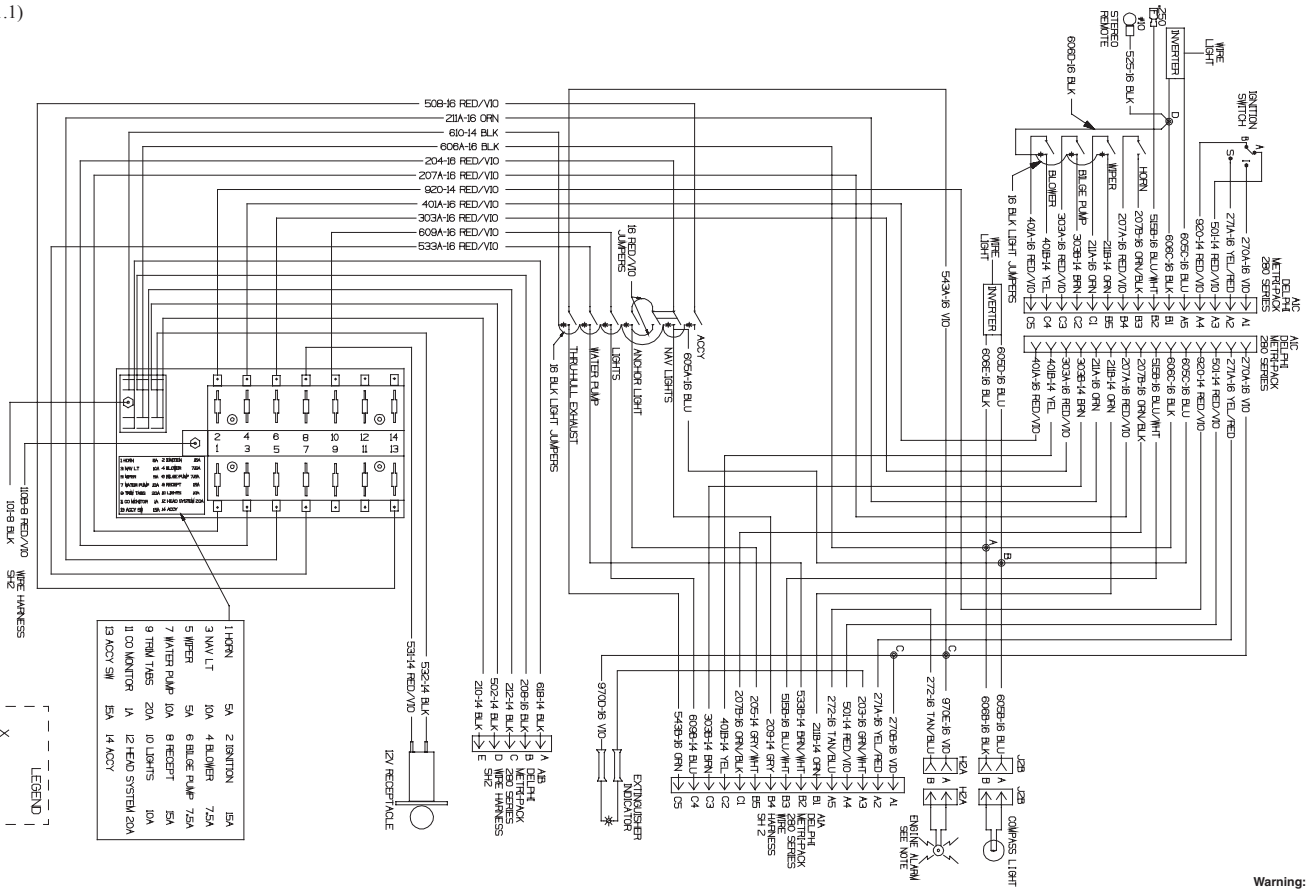

# ELECTRICAL SCHEMATICS, 200 SUNDECK (CONTINUED)

DC WIRING DIAGRAM (2 OF 2)  
DRAWING NO. 09-603  
(FIG. 12.1)

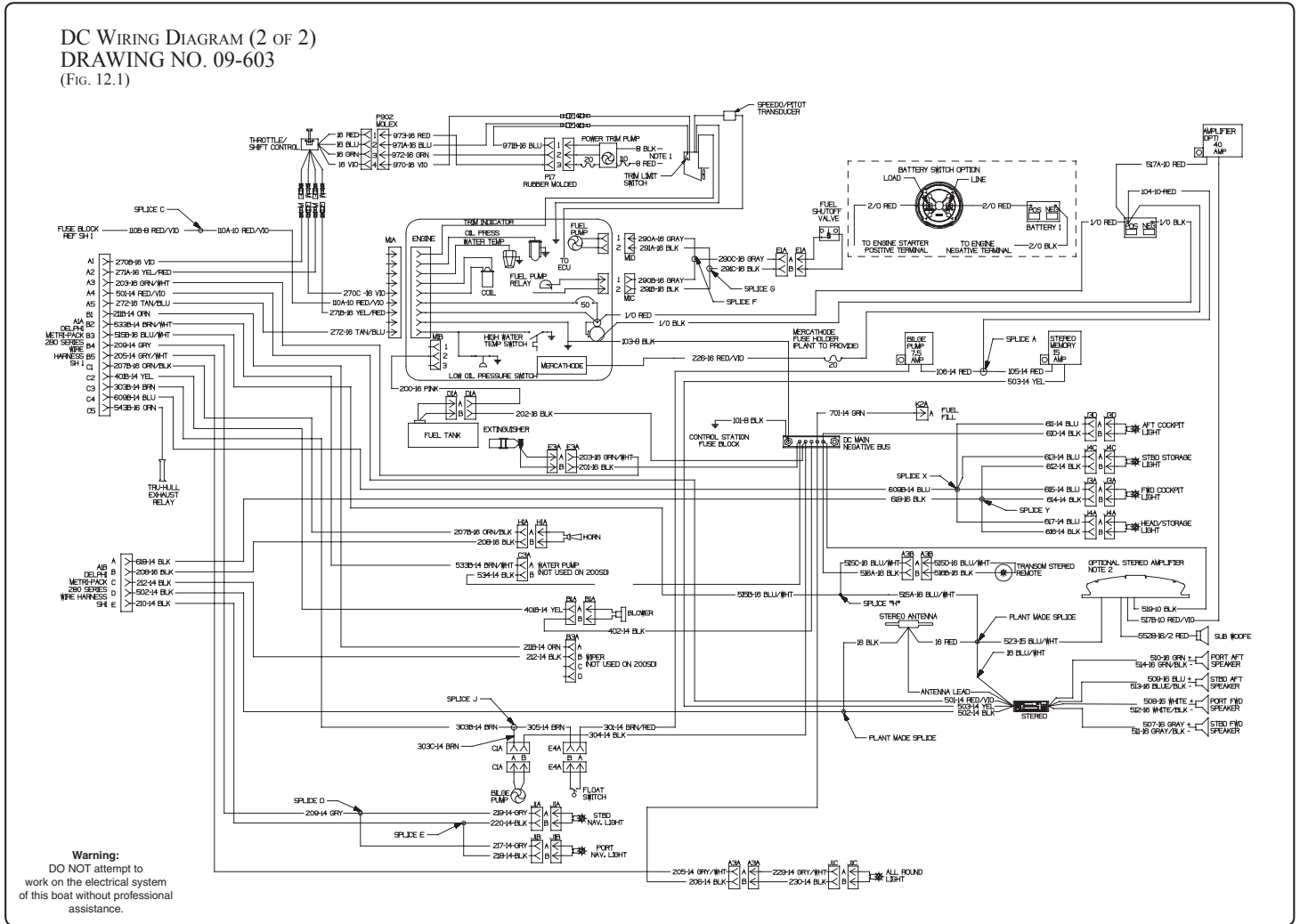

## ELECTRICAL SCHEMATICS, 200 SUNDECK (CONTINUED)

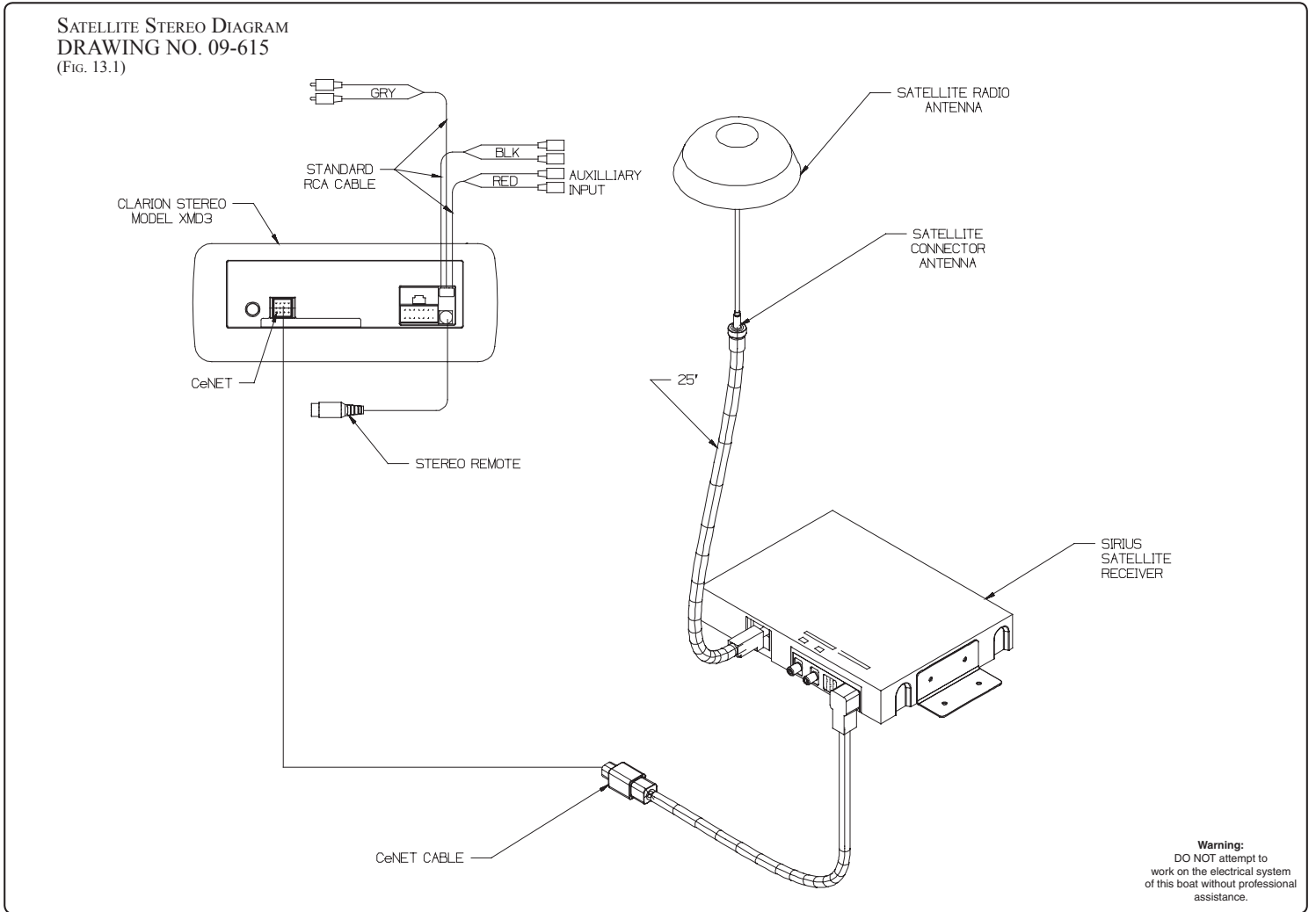

# ELECTRICAL SCHEMATICS, 200 SUNDECK (CONTINUED)

SMARTCRAFT SYSTEMS DIAGRAM  
DRAWING NO. 09-710  
(Fig. 14.1)

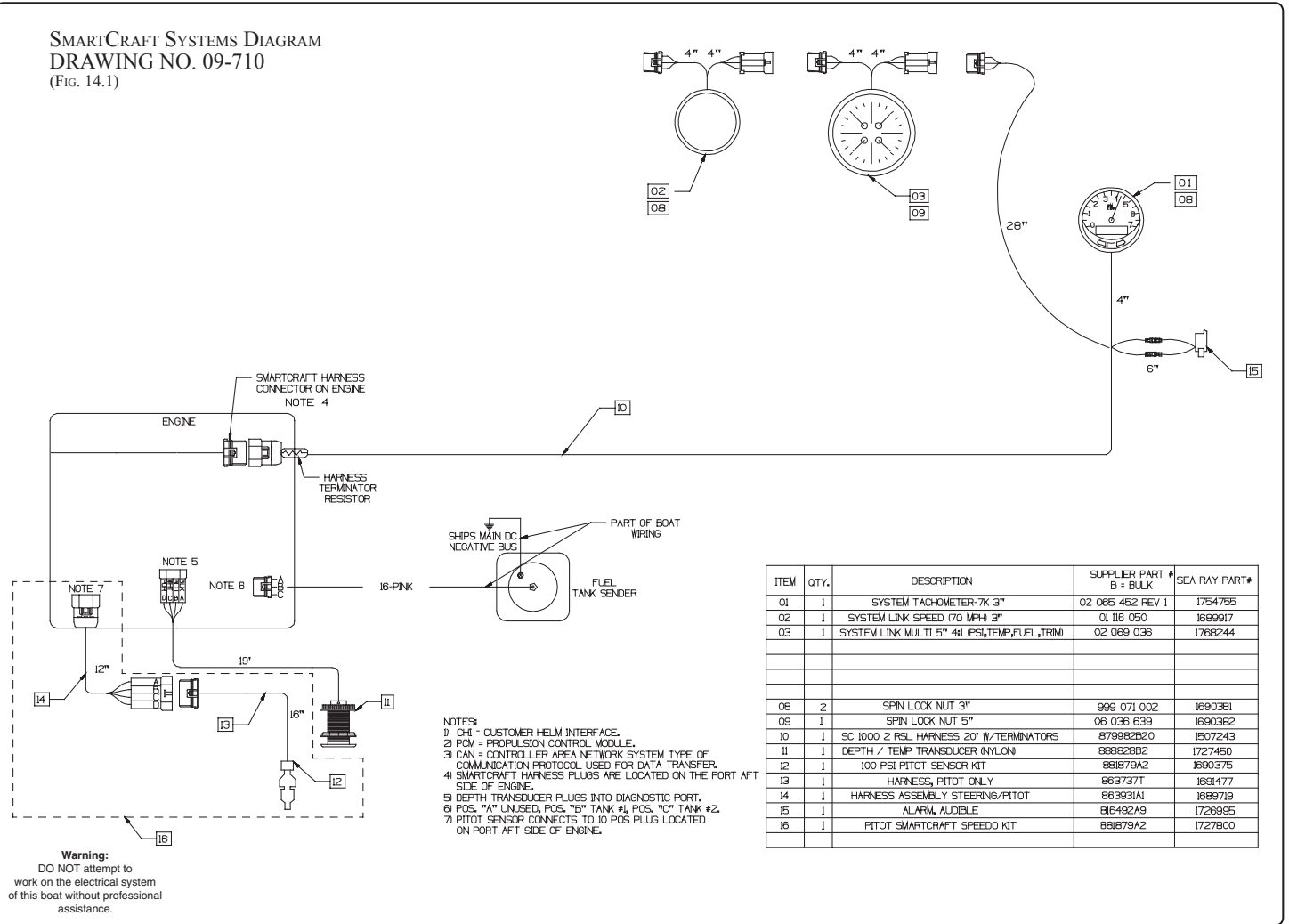

- NOTES:  
 1) CHI = CUSTOMER HELM INTERFACE.  
 2) PCM = PROPULSION CONTROL MODULE.  
 3) CAN = CONTROLLER AREA NETWORK SYSTEM TYPE OF COMMUNICATION PROTOCOL USED FOR DATA TRANSFER.  
 4) SMARTCRAFT HARNESS PLUGS ARE LOCATED ON THE PORT AFT SIDE OF ENGINE.  
 5) DEPTH TRANSDUCER PLUGS INTO DIAGNOSTIC PORT.  
 6) POS. "A" UNUSED, POS. "B" TANK #1, POS. "C" TANK #2.  
 7) PITOT SENSOR CONNECTS TO 10 POS PLUG LOCATED ON PORT AFT SIDE OF ENGINE.

ITEM	QTY.	DESCRIPTION	SUPPLIER PART # B = BULK	SEA RAY PART#
01	1	SYSTEM TACHOMETER-7K 3"	02 065 452 REV 1	1754795
02	1	SYSTEM LINK SPEED (70 MPH) 3"	01 118 050	1689917
03	1	SYSTEM LINK MULTI 5" 41 (PSI,TEMP,FUEL,TRIM)	02 069 036	1768244
08	2	SPIN LOCK NUT 3"	999 071 002	1690381
09	1	SPIN LOCK NUT 5"	06 036 639	1690382
10	1	SC 1000 2 PSL. HARNESS 20' W/TERMINATORS	879982B20	1507243
11	1	DEPTH / TEMP TRANSDUCER (NYLON)	888828B2	1727450
12	1	100 PSI PITOT SENSOR KIT	88879A2	1690375
13	1	HARNESS, PITOT ONLY	863737T	1691477
14	1	HARNESS ASSEMBLY STEERING/PITOT	863931A1	1689719
15	1	ALARM, AUDIBLE	816492A9	1726995
16	1	PITOT SMARTCRAFT SPEEDO KIT	88879A2	1727900







## ELECTRICAL SCHEMATICS, 200 SUNDECK (CONTINUED)

WIRE HARNESS INSTALLATION, (3 OF 3)  
DRAWING NO. 09-875  
(FIG. 16.1)

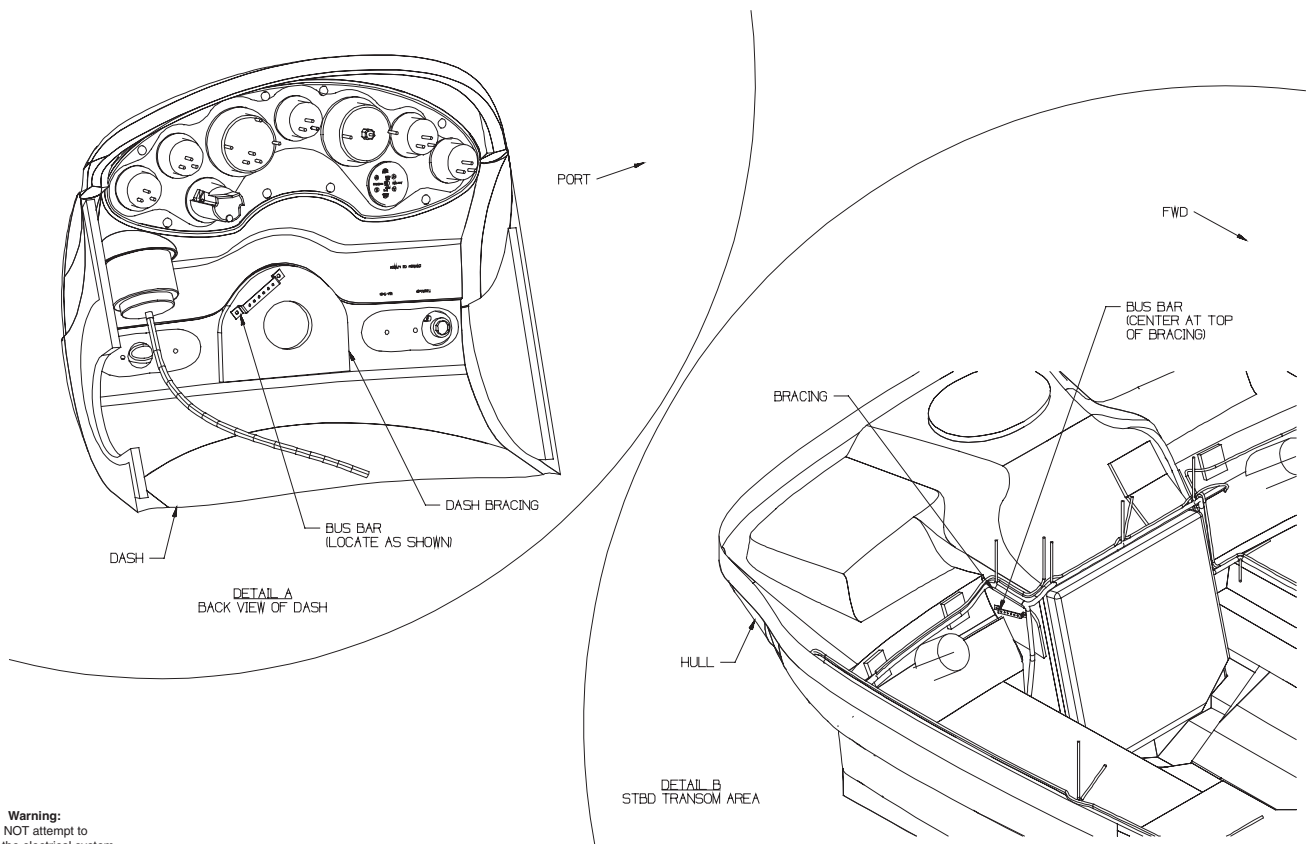

**Warning:**  
DO NOT attempt to  
work on the electrical system  
of this boat without professional  
assistance.



---

# INDEX

---

## A

Anchor Lights..... 8

## C

Canvas..... 9  
Clearances ..... 4  
Cleats ..... 8

## D

Deck Layout..... 7  
Dimensions..... 4

## E

Electrical Schematics ..... 10

## F

Fuel System..... 8

## G

Gauge Layout ..... 6

## H

Helm Layout..... 6

## N

Navigation Lights ..... 8

## P

Passenger Locations ..... 1

## S

Safety Label Locations ..... 2  
Switch Layout ..... 6

## T

Through-Hull Cutouts ..... 5  
Trailer Trim Switch..... 9

## W

Water Sports Tower ..... 10

